



Instructions for use



CE
0297

Surgical

Handpieces
S-9, S-10, S-11, S-12, S-15

Contents

Symbols	4
1. Introduction	6
2. Safety notes	9
3. Product description	11
4. Operation	13
Assembly/Removal	13
To change rotary instrument	16
Test run	17
5. Hygiene and maintenance	18
General notes.....	18
Limitations on processing	20
Initial treatment at the point of use	21
Manual cleaning	22
Manual disinfection	29

Automated cleaning and disinfection	30
Drying	31
Inspection, Maintenance and Testing	32
Packaging	39
Sterilization.....	40
Storage	43
6. Servicing	44
7. Accessories, consumables, spare parts and other recommended medical devices by W&H.....	45
8. Technical data	46
9. Disposal	49
Explanation of warranty terms	50
Authorized W&H service partners.....	51

Symbols



WARNING!
(risk of injury)



ATTENTION!
(to prevent
damage occurring)



General explanations,
without risk to
persons or objects



Do not dispose of
with domestic waste

R_x_{only}

Caution!

Federal law restricts this device to sale by or on the order of a dentist, physician, veterinarian or with the descriptive designation of any other practitioner licensed by the law of the State in which the practitioner practices to use or order the use of the device.



Manufacturer

Symbols



CE marking
with identification number
of the Notified Body



DataMatrix Code
for product information
including UDI (Unique
Device Identification)



Data structure in
accordance with Health
Industry Bar Code



Catalogue number



Thermo washer
disinfectable



Sterilizable up to the
stated temperature



Serial number



Medical Device



Date of manufacture



Consult Instructions for Use

1. Introduction

Customer satisfaction has absolute priority in the W&H quality policy. This medical device has been developed, manufactured and subjected to final inspection according to legal regulations, quality and industry standards.

For your safety and the safety of your patients

Prior to initial use please read the Instructions for use. These explain how to use your medical device and guarantee a smooth and efficient operation.



Observe the safety notes.

Intended use

Surgical treatment of organic hard tissue.



Misuse may damage the medical device and hence cause risks and hazards for patient, user and third parties.



Qualifications of the user

We have based our development and design of the medical product on the »physician« target group.

Responsibility of the manufacturer

The manufacturer can only accept responsibility for the safety, reliability and performance of the medical device when it is used in compliance with the following directions:

- > The medical device must be used in accordance with these Instructions for use.
- > The medical device has no components that can be repaired by the user.
- > Modifications or repairs must only be undertaken by an authorized W&H service partner (see page 53).



Skilled application

The medical device is intended only for skilled application according to the intended use as well as in compliance with the valid health and safety at work regulations, the valid accident prevention regulations and in compliance with these Instructions for use.

The medical device should be prepared for use and maintained by staff who have been trained in procedures for infection control, personal safety and patient safety.

Improper use, (e.g., through poor hygiene and maintenance), non-compliance with our instructions or the use of accessories and spare parts which are not approved by W&H, invalidates all claims under warranty and any other claims.



Any serious incident that has occurred in relation to the medical device should be reported to the manufacturer and the competent authority!

2. Safety notes



- > Before using the medical device for the first time, store it at room temperature for 24 hours.
- > The operation of the medical device is permitted only on supply units which correspond to the standards IEC 60601-1 (EN 60601-1) and IEC 60601-1-2 (EN 60601-1-2).
- > Do not activate the chuck lever of the medical device during operation. This leads to detachment of the rotary instrument and/or makes the medical device hot.
- > Always ensure the correct operating conditions and cooling function.
- > Always ensure that sufficient and adequate cooling is delivered and ensure adequate suction.
- > In case of coolant supply failure, the medical device must be stopped immediately.
- > Check the medical device for damage and loose parts each time before using .
- > Do not operate the medical device if it is damaged.
- > Only attach the medical device onto the motor when the motor is at a complete standstill.
- > Perform a test run each time before using.
- > Avoid overheating at the treatment site.
- > Do not touch the soft tissue with the handpiece head (risk of burning)!

Hygiene and maintenance prior to initial use



- > The medical device is sealed in PE film and not sterilized when delivered.
- > The PE film and the packaging are non-sterilizable.



- > Clean, disinfect and lubricate the medical device.
- > Sterilize the medical device, the nozzle cleaner and the coolant tube.

3. Product description

S-11, S-15

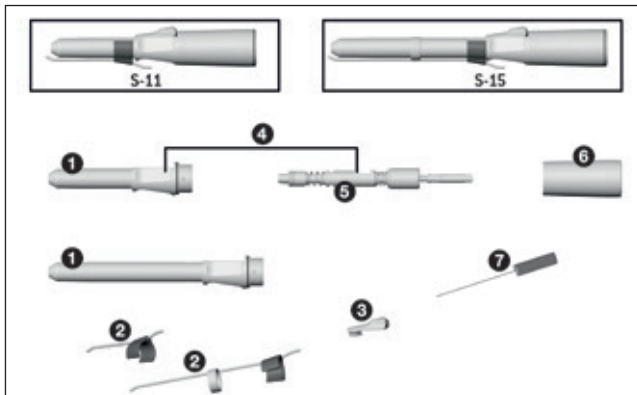

- ① Handpiece head*
- ② Coolant tube (movable)
- ③ Chuck lever
- ④ Area of chuck lever
- ⑤ Shaft
- ⑥ Sheath*
- ⑦ Long nozzle cleaner

* Symbols on the parts ① and ⑥

○ = Sheath open

↔ = Direction of rotation

▲ = Sheath locked

3. Product description

S-9, S-10, S-12

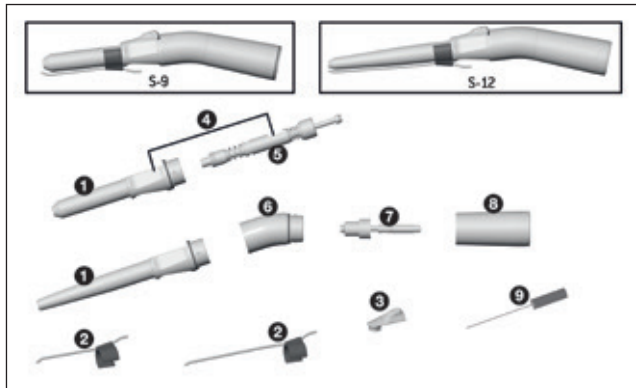

- 1 Handpiece head*
- 2 Coolant tube (movable)
- 3 Chuck lever
- 4 Area of chuck lever
- 5 Shaft
- 6 Knee*
- 7 Lower shaft
- 8 Sheath*
- 9 Long nozzle cleaner

* Symbols on the parts 1, 6 and 8

○ = Sheath open

↔ = Direction of rotation

▲ = Sheath locked

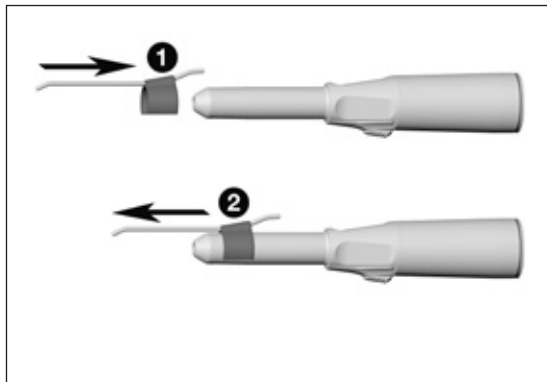

Coolant tube

- 1 Fit the coolant tube.



Check the secure hold of the coolant tube and replace it if necessary.

or

- 2 Pull off the coolant tube.

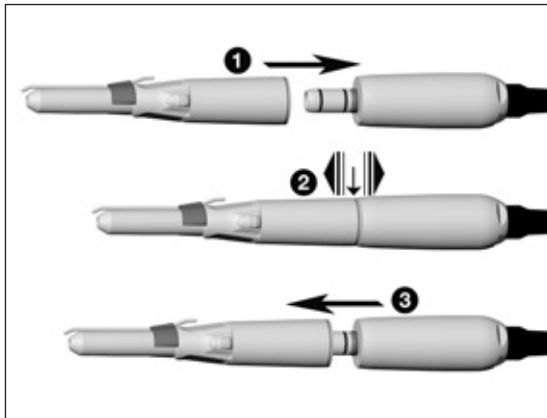

Do not assemble or remove the medical device during operation!

1 Push the medical device onto the motor.



When using a locking pin between motor and medical device: See Instructions for use of the control unit.



2 Verify full engagement.

3 Remove the medical device.

Rotary instruments



- > Use only rotary instruments which are in perfect condition and pay attention to the direction of rotation of the rotary instrument. Follow the operating instructions of the manufacturer.
- > Insert the rotary instrument only when the medical device is stationary.
- > Never touch the rotary instrument while it is still rotating.
- > Do not activate the chuck lever of the medical device during operation. This leads to detachment of the rotary instrument, damage to the chucking system and/or heating up of the medical device.
Risk of burning!

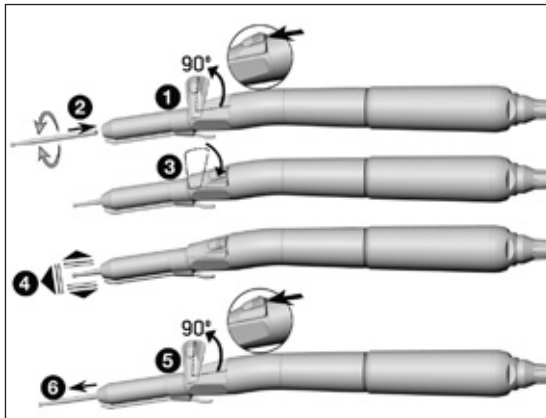

To change rotary instrument

- 1 Unlock and swivel the chuck lever.
- 2 Insert the rotary instrument until limit stop.
- 3 Return the chuck lever to the initial position.



- 4 Verify full engagement.

or

- 5 Unlock and swivel the chuck lever.
- 6 Remove the rotary instrument.

Test run



Do not hold the medical device at eye level!

- > Insert the rotary instrument.
- > Operate the medical device



In the event of operating malfunctions (e.g., vibrations, unusual noise, overheating, coolant failure or leakage) **stop the medical device immediately** and contact an authorized W&H service partner.



- > Follow your local and national laws, directives, standards and guidelines for cleaning, disinfection and sterilization.



- > Wear protective clothing, safety glasses, face mask and gloves.



- > Use only oil-free, filtered compressed air with a maximum operating pressure of 3 bar for manual drying.

Cleaning agents and disinfectants



- > Read the notes, follow the instructions and heed the warnings provided by the manufacturers of cleaning agents and/or disinfectants.
- > Use only detergents which are intended for cleaning and/or disinfecting medical devices made of metal and plastic.
- > It is imperative to comply with the concentrations and exposure times specified by the manufacturer of the disinfectant.
- > Use disinfectants which have been tested and found effective by, for example: the Verbund für Angewandte Hygiene e.V. (VAH = Association for Applied Hygiene), the Österreichische Gesellschaft für Hygiene, Mikrobiologie und Präventivmedizin (ÖGHMP = Austrian Society for Hygiene, Microbiology and Preventive Medicine), the Food and Drug Administration (FDA) and the U.S. Environmental Protection Agency (EPA).



The user is responsible for validating its process if the specified cleaning agents and disinfectants are not available.



The product lifetime and the medical device's ability to operate correctly are mainly determined by mechanical stress during use and chemical influences due to processing.

- > Send worn or damaged medical devices and/or medical devices with material changes to an authorized W&H service partner.

Processing cycles



- > We recommend a regular service for the W&H medical device after 500 processing cycles or one year.



Clean the medical device immediately after every treatment, to flush out any liquid (e.g., blood, saliva etc.) and to prevent settling on the internal parts.

- > Operate the medical device for at least 10 seconds at idle speed.
- > Ensure that all outlets are rinsed out.



- > Wipe the entire surface of the medical device with disinfectant.
- > Remove the rotary instrument.
- > Remove the medical device.



Note that the disinfectant used during pre-treatment is only for personal protection and cannot replace the disinfectant step after cleaning.

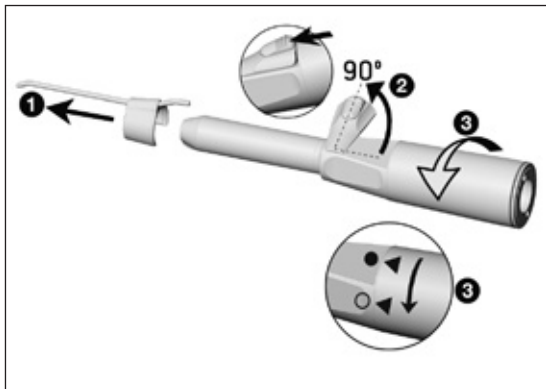

Disassembling the straight medical device S-11, S-15

- 1** Pull off the coolant tube.
- 2** Unlock and swivel the chuck lever.
- 3** Twist the sheath off the handpiece head by turning it once.

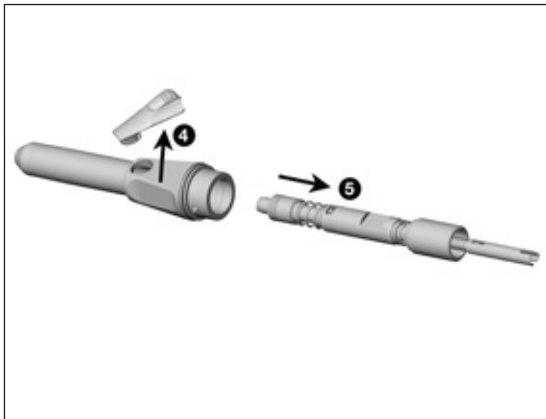

- ④ Remove the chuck lever.
- ⑤ Remove the shaft from the handpiece head.

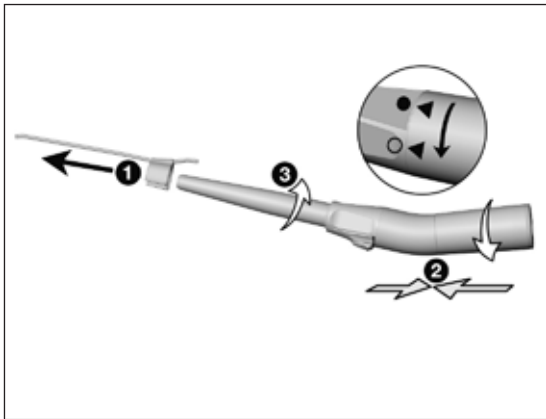

Disassembling the angled medical device S-9, S-10, S-12

- 1 Pull off the coolant tube.
- 2 Press sheath firmly against knee.
- 3 Twist the sheath off the handpiece head by turning it once.

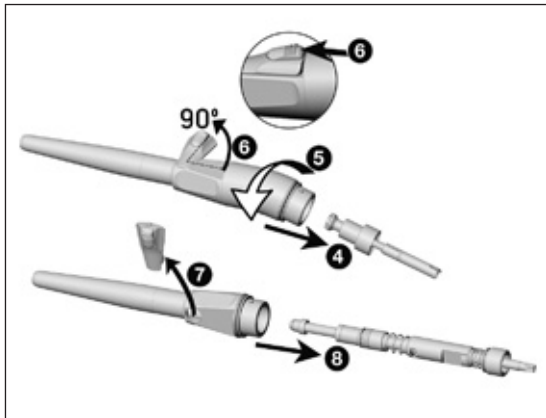

- ④ Remove the lower shaft from the knee.
- ⑤ Twist the knee from the handpiece head.
- ⑥ Unlock and swivel the chuck lever.
- ⑦ Pull off the shaft until limit stop and remove the chuck lever.
- ⑧ Remove the shaft from the handpiece head.



Do not place the medical device in liquid disinfectant or in an ultrasonic bath.

- > Clean the medical device under running tap water (< 35°C / < 95°F).
- > Rinse and brush off all internal and external surfaces.
- > Move moving parts back and forth several times.
- > Remove liquid residues using compressed air.

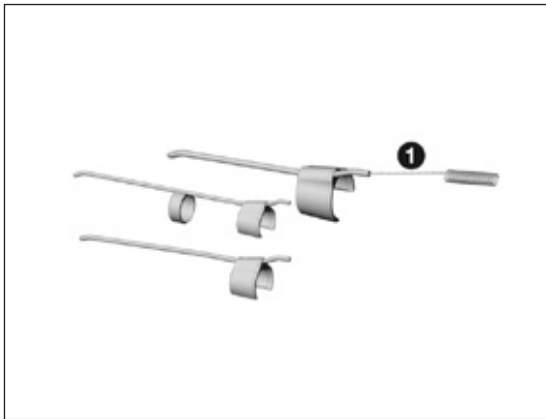

Cleaning the coolant tube



The coolant tube and the nozzle cleaner can be cleaned in an ultrasonic bath and/or in the washerdisinfector.

- 1 Clean coolant outlets carefully with the nozzle cleaner to remove dirt and deposits.

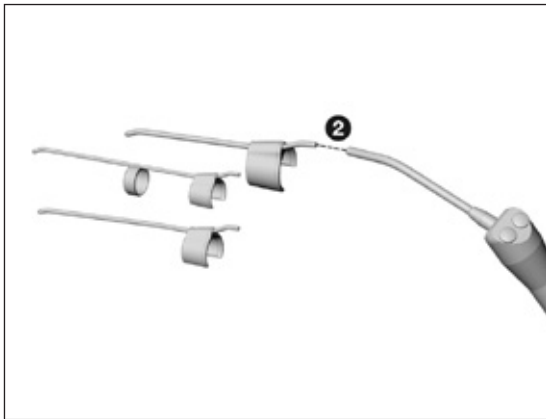

2 Blow through the coolant tube and coolant outlets using compressed air.



In case of blocked coolant outlets or coolant tubes contact an authorized W&H service partner.



> W&H recommends wiping down with disinfectant.



Evidence of the medical device's basic suitability for effective manual disinfection was provided by an independent test laboratory using the disinfectants "mikrozid® AF wipes" (Schülke & Mayr GmbH, Norderstedt) and "CaviWipes™" (Metrex).



W&H recommends automated cleaning and disinfection using a washer-disinfector (WD).

- > Read the notes, follow the instructions and heed the warnings provided by the manufacturers of thermal washer disinfectors, cleaning agents and/or disinfectants and thermal washer disinfector adaptors.

External coolant tubes and spray clips

Only use approved and validated adaptors for products with voids for your thermal washer disinfector.



Evidence of the medical device's basic suitability for effective automated disinfection was provided by an independent test laboratory using the "Miele PG 8582 CD" washer-disinfector (Miele & Cie. KG, Gütersloh) and the "Dr. Weigert neodisher® MediClean forte" cleaning agent (Dr. Weigert GmbH & Co. KG, Hamburg) according to ISO 15883.

- > Cleaning at 55°C (131°F) – 5 minutes
- > Disinfection at 93°C (200°F) – 5 minutes



- > Ensure that the medical device is completely dry internally and externally after cleaning and disinfection.
- > Remove liquid residues using compressed air.

Inspection



- > Check the medical device after cleaning and disinfection for damage, visible residual soiling and surface changes.
- > Reprocess any medical devices that are still soiled.
- > Sterilize the reassembled medical device following cleaning, disinfection and lubrication.

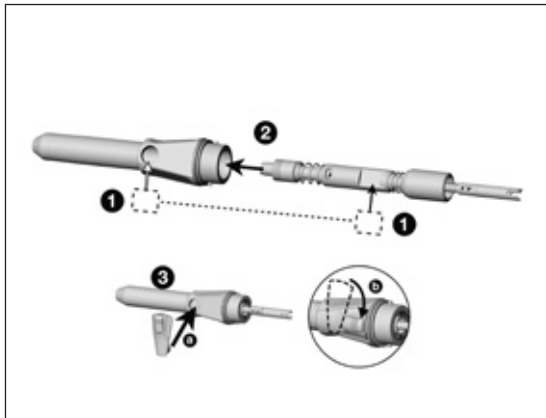

Reassembling the straight medical device



Reassemble the medical device following cleaning and disinfection.

- > Without coolant tube
- > Type and serial numbers must be identical

- 1 Note the positioning of the area of chuck lever
- 2 Insert the shaft into the handpiece head.
- 3 Insert chuck lever (a) and turn it to initial position (b).

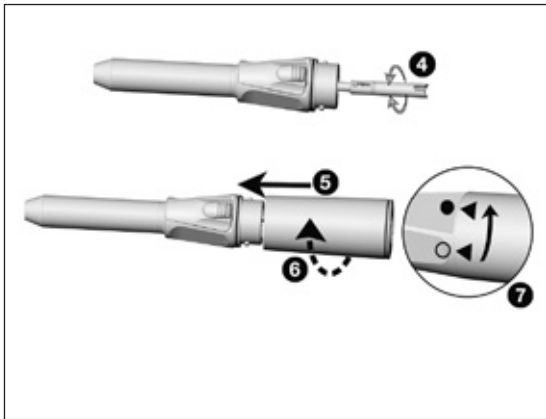

- 4 Push the shaft into the handpiece head.
Check free running of the shaft.
- 5 Insert the sheath onto the handpiece head.
- 6 Turn the sheath until it engages audibly.
- 7 Note the symbols and turn until locked.

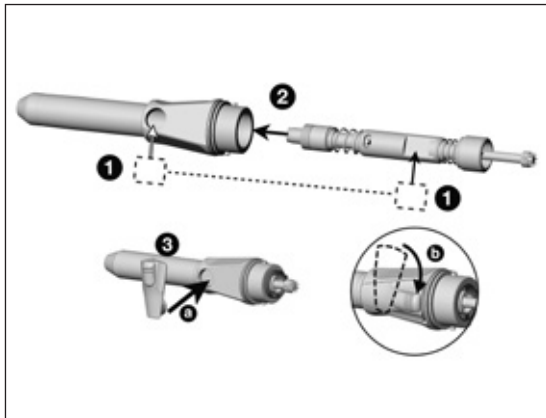

Reassembling the angled medical device



Reassemble the medical device following cleaning and disinfection.

- > Without coolant tube
- > Type and serial numbers must be identical

- 1 Note the positioning of the area of chuck lever
- 2 Insert the shaft into the handpiece head.
- 3 Insert chuck lever (a) and turn it to initial position (b).

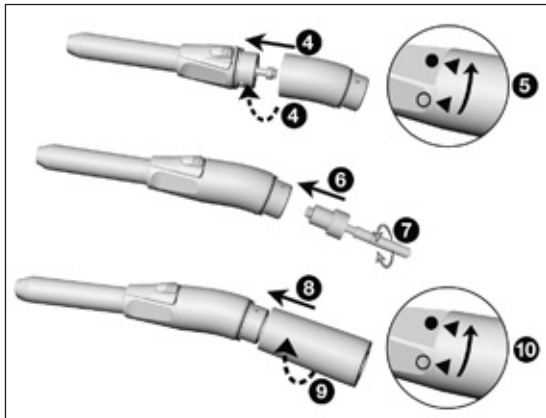

- ④ Push the shaft into the handpiece head.
Insert the knee onto the handpiece head.
- ⑤ Note the symbols and turn until locked.
- ⑥ Insert lower shaft into the knee.
- ⑦ Check free running of the lower shaft.
- ⑧ Insert sheath onto the knee.
- ⑨ Turn the sheath until it engages audibly.
- ⑩ Note the symbols and turn until locked.

Lubrication



- > Lubricate the dry medical device immediately after cleaning and/or disinfection.

Recommended lubrication cycles

- > Essential after every internal cleaning
- > Before each sterilization

With W&H Service Oil F1, MD-400

- > Follow the instructions on the oil spray can and on the packaging.
- or

With W&H Assistina

- > Follow the instructions in the Assistina Instructions for use.

Test after lubrication



- > Direct the medical device downwards.
- > Operate the medical device so that excess oil can escape.
- > Remove any oil that has escaped.
- > Excess oil may result in the medical device overheating.



Pack the medical device and the accessories in sterilization packages that meet the following requirements:

- > The sterilization package must meet the applicable standards in respect of quality and use and must be suitable for the sterilization method.
- > The sterilization package must be large enough for the sterilization method.
- > The filled sterilization package must not be under tension.



W&H recommends sterilization according to EN 13060, EN 285 or ANSI/AAMI ST55.



- > Read the notes, follow the instructions and heed the warnings provided by the manufacturers of steam sterilizers.
- > The program selected must be suitable for the medical device.



- > Pull off the coolant tube from the medical device before sterilization.
- > Sterilize the medical device, the nozzle cleaner and the coolant tube.

Recommended sterilization procedures

- > “Dynamic-air-removal prevacuum cycle” (type B) / “Steam-flush pressure-pulse cycle” (type S)*/**
134°C (273°F) for at least 3 minutes, 132°C (270°F) for at least 4 minutes
- > “Gravity-displacement cycle” (type N)**
121°C (250°F) for at least 30 minutes
- > Maximum sterilization temperature 135°C (275°F)



Evidence of the medical device's basic suitability for effective sterilization was provided by an independent test laboratory using the LISA 517 B17L* steam sterilizer (W&H Sterilization S.r.l., Brusaporto (BG)), the Systec VE-150* steam sterilizer (Systec) and the CertoClav MultiControl MC2-S09S273** steam sterilizer (CertoClav GmbH, Traun).

“Dynamic-air-removal prevacuum cycle” (type B):	134°C (273°F) – 3 minutes*, 132°C (270°F) – 4 minutes*/**
“Steam-flush pressure-pulse cycle” (type S):	134°C (273°F) – 3 minutes*, 132°C (270°F) – 4 minutes*/**
“Gravity-displacement cycle” (type N):	121°C (250°F) – 30 minutes**
Drying times:	
“Dynamic-air-removal prevacuum cycle” (type B):	132°C (270°F) – 30 minutes**
“Steam-flush pressure-pulse cycle” (type S):	132°C (270°F) – 30 minutes**
“Gravity-displacement cycle” (type N):	121°C (250°F) – 30 minutes**

* EN 13060, EN 285, ISO 17665

** ANSI/AAMI ST55, ANSI/AAMI ST79



- > Store sterile goods dust-free and dry.
- > The shelf life of the sterile goods depends on the storage conditions and type of packaging.

6. Servicing

Repairs and returns

In the event of operating malfunctions immediately contact an authorized W&H service partner.

Repairs and maintenance work must only be undertaken by an authorized W&H service partner.



Ensure that the medical device has been completely processed before returning it.

7. Accessories, consumables, spare parts and other recommended medical devices by W&H



Use only original W&H accessories and spare parts or accessories approved by W&H.

Supplier: W&H partners

000301xx Assistina 301 plus

30310000 Assistina TWIN (MB-302)

10940021 Service Oil F1, MD-400 (6 pcs)

02038200 Spray adaptor

00636901 Long nozzle cleaner

07978680 Coolant tube for S-9, S-11

08026210 Coolant tube for S-10, S-12

08026950 Coolant tube for S-15

8. Technical data

	S-11	S-15
Transmission ratio	1:1	1:1
Colour coding	blue	blue
Motor connection according to standard	ISO 3964	ISO 3964
Rotary instruments ISO 1797 (Ø mm)	2.35*	2.35*
Permitted bur length** (mm)	45	45
Minimum chucking length	until limit stop	until limit stop
Maximum drive speed** (min ⁻¹)	50,000	30,000
Coolant volume ISO 14457 (ml/min)	> 50	> 50

min⁻¹ (Revolutions per minute)

* System Stryker usable



** When using longer or shorter rotary instruments the user must ensure by correct selection of the operating conditions, that there is no danger to the user, patient or third parties.

For safe use, follow the respective manufacturer's instructions regarding maximum speed of the rotating instrument.

Technical data

		S-9	S-10	S-12
Transmission ratio		1:1	1:1	1:2
Colour coding		blue	blue	orange
Motor connection according to standard		ISO 3964	ISO 3964	ISO 3964
Rotary instruments	ISO 1797 (Ø mm)	2.35*	2.35	2.35
Permitted bur length**	(mm)	45	70	70
Minimum chucking length		until limit stop	until limit stop	until limit stop
Maximum drive speed**	(min ⁻¹)	50,000	50,000	40,000
Coolant volume	ISO 14457 (ml/min)	> 50	> 50	> 50

min⁻¹ (Revolutions per minute)

* System Stryker usable



** When using longer or shorter rotary instruments the user must ensure by correct selection of the operating conditions, that there is no danger to the user, patient or third parties.

For safe use, follow the respective manufacturer's instructions regarding maximum speed of the rotating instrument.

Temperature information



Temperature of the medical device on the operator side: maximum 55°C (131°F)

Temperature of the medical device on the patient side: maximum 50°C (122°F)

Temperature of the working part (rotary instrument): maximum 41°C (105.8°F)

Ambient conditions

Temperature during storage and transport:

-40°C to +70°C (-40°F to +158°F)

Humidity during storage and transport:

8 % to 80 % (relative), non-condensing

Temperature during operation:

+10°C to +35°C (+50°F to +95°F)

Humidity during operation:

15 % to 80 % (relative), non-condensing

9. Disposal



Ensure that the parts are not contaminated on disposal.



Follow your local and national laws, directives, standards and guidelines for disposal.

- > Medical device
- > Packaging

Explanation of warranty terms

This medical device has been manufactured with great care by highly qualified specialists. A wide variety of tests and controls guarantees faultless operation. Please note that claims under warranty can only be validated when all the directions in the Instructions for Use have been followed.

As manufacturer, W&H is liable for material or manufacturing defects within a warranty period of 12 months from the date of purchase. Accessories and consumables are excluded from the warranty.

We accept no responsibility for damage caused by incorrect handling or by repairs carried out by third parties not authorized to do so by W&H!

Claims under warranty accompanied by proof of purchase must be sent to the vendor or to an authorized W&H service partner. The provision of service under warranty extends neither the warranty period nor any other guarantee period.

12 months warranty

Authorized W&H service partners

Find your nearest authorized W&H service partner at <http://wh.com>
Simply go to the menu option “Service” for full details.

Or simply scan the QR code.





W&H Dentalwerk Bürmoos GmbH

Ignaz-Glaser-Straße 53, 5111 Bürmoos, Austria

t + 43 6274 6236-0,

office@wh.com

f + 43 6274 6236-55

wh.com

Form-Nr. 51019 AEN

Rev. 004 / 05.12.2023

Subject to alterations