

Instructions for Use

Edition USA



CE

assistina^{TWIN}

MB-302

Contents

Symbols	4
1. Introduction	7
2. Electromagnetic compatibility (EMC)	9
3. Unpacking	10
4. Scope of delivery	11
5. Safety notes	12
6. Description	14
Front panel	14
LED display	15
Quick ISO/Quick RM adaptor	16
Rear panel	17
7. Start-up	18
Inserting/removing a cartridge	18
Inserting/removing a filter	19
General	20
Switching the Assistina Twin on/off	21
Activating/deactivating the blow-through function [optional]	22
Initial filling	23
Standby mode	25
Test run	26
8. Operation	27
General	27
Loading/removing with Quick ISO adaptor	28
Loading/removing with Quick RM adaptor	29
Maintenance process	31
Lubrication of the chucking system	33

Contents

9. Cleaning.....	36
10. Maintenance	39
11. Error messages.....	41
12. Accessories, consumables, spare parts and other recommended medical devices by W&H.....	46
13. Servicing	48
14. Technical data	49
15. Disposal	51
Explanation of warranty terms	52
Authorized W&H service partners.....	53

Symbols

in the Instructions for Use



WARNING!
[risk of injury]



ATTENTION!
[to prevent damage occurring]



General explanations,
without risk to
persons or property



CE mark



Do not dispose of with
domestic waste

Symbols

on the medical device



Consult Instructions
for Use



Do not dispose of with domestic
waste



Catalogue number



Date of manufacture



Manufacturer



Serial number



CE mark



Supply voltage
of the unit



Data Matrix code for product
information including UDI
(Unique Device Identification)



Medical Device



DC – direct current

Symbols



This way up



Fragile, handle with care



Keep dry



“Der Grüne Punkt” (The Green Dot) trademark of Duales System Deutschland GmbH



Manufacturer



Medical Device



CE mark



Keep away from heat



Use by

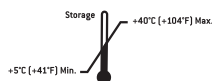

Permitted temperature range for storage

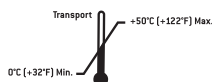

Permitted temperature range for transport:

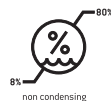

Humidity limitation



Consult Instructions for Use



Trademark of RESY OfW GmbH for identification of recyclable transport and outer packaging of paper and cardboard



Caution! According to Federal law restricts this device to sale by or on the order of a physician, dentist, veterinarian or with the descriptive designation of any other practitioner licensed by the law of the State in which the practitioner practices to use or order the use of the device.

1. Introduction

For your safety and the safety of your patients

Prior to initial use please read the Instructions for Use. These explain how to use your medical device and guarantee a smooth and efficient operation.



Observe the safety notes.

Intended use

Unit for cleaning the spray channels and lubricating the moving parts of dental and surgical handpieces, turbines, air motors and air-driven dental scalers.



Misuse may damage the medical device and hence cause risks and hazards for user and third parties.

When transmission instruments are prepared with the medical device, they are neither disinfected nor sterilized. After cleaning of the spray channels and lubrication of the transmission instruments with the medical device, they subsequently need to be disinfected and sterilized.

Qualifications of the user

We have based the development and design of the medical device on the target group of dentists, dental hygienists and dental assistants.

Introduction

Responsibility of the manufacturer

The manufacturer can only accept responsibility for the safety, reliability and performance of the medical device when it is used in compliance with the following directions:

- > The medical device must be used in accordance with these Instructions for Use.
- > The medical device has no components that can be repaired by the user (with the exception of replacing the O-rings, cartridges, filter and air filter). Assembly, modifications or repairs must only be undertaken by an authorized W&H service partner (see page 53).
- > The electrical installation at the premises must comply with the regulations laid out in IEC 60364-7-710 ("Installation of electrical equipment in rooms used for medical purposes") or with the regulations applicable in your country.
- > Unauthorized opening of the equipment invalidates all claims made under warranty and any other claims.

Improper use and unauthorized assembly, installation and modification of or repairs to the medical device or failure to comply with our instructions invalidates all claims under warranty and releases us from all other claims!



Any serious incident that has occurred in relation to the medical device should be reported to the manufacturer and the competent authority!

2. Electromagnetic compatibility (EMC)



Medical electrical equipment is subject to particular precautions in regard to EMC and must be installed and put into operation in accordance with the EMC notes included.

W&H guarantees the compliance of the device with the EMC requirements only when used with original W&H accessories and spare parts. The use of accessories and spare parts not approved by W&H can lead to an increased emission of electromagnetic interference or to a reduced resistance against electromagnetic interference.

3. Unpacking

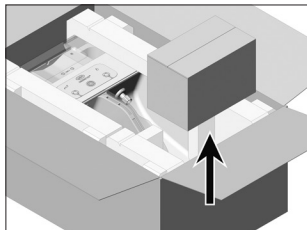

- 1 Remove the cardboard box with the Twin Care SET.

W&H packaging is environmentally friendly and can be disposed of by industrial recycling companies.

However, we recommend that you keep the original packaging.

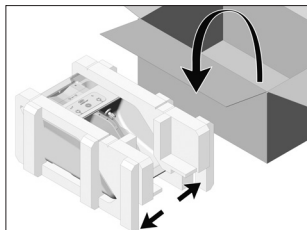

- 2 Lift out the medical device.

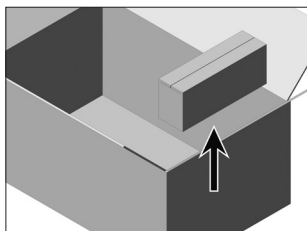

- 3 Remove the cardboard box with the:
 - > air connection hose;
 - > power supply unit.

4. Scope of delivery

		W&H Assistina TWIN (MB-302)			
		REF 30310000	REF 30310001	REF 30310002	REF 30310003
REF 02697000	Air connection hose	X	X	X	X
REF 07477500	Power supply unit MB-302	X	X	X	X
REF 07484000	Twin Care SET MB-302: > W&H Activefluid cartridge, MC-302, 200 ml > W&H Service Oil F1 cartridge, MD-302, 200 ml > filter	X	X	X	X
REF 06422600	Quick ISO adaptor		X*		X
REF 06395100	Quick RM adaptor			X*	X

*Scope of delivery: 2 pcs

5. Safety notes



Please observe the following instructions under all circumstances

- > Before using the medical device for the first time, store it at room temperature for 24 hours.
- > Only set up the product in sufficiently well ventilated rooms!
- > Always ensure the correct operating conditions.
- > Check the medical device for damage, leakage and loose parts each time before using (e.g., adaptor, filter compartment cover).
- > Always close the sliding window before you use the medical device!
- > Keep the medical device closed during the maintenance process!

Power supply unit

- > Only use the power supply unit supplied.
- > Ensure that the medical device can be disconnected from the power supply at any time.
- > Disconnect the medical device in dangerous situations from the power supply.
Pull the power supply out of the socket.



Place the medical device on a flat, level surface.

Safety notes



The medical device is classed as "conventional equipment" (closed equipment without protection against the ingress of water).

Process fluids



- > If inhaled: Supply fresh air; consult doctor in case of complaints.
- > Following contact with skin: Wash off with soap and plenty of water.
- > Following contact with eyes: Rinse opened eye for several minutes under running water. If symptoms persist, consult a doctor.
- > If swallowed: If symptoms persist, consult a doctor.
- > Only use process fluids which have been approved by the manufacturer.

Approved process fluids

- > W&H Activefluid, MC-302
- > W&H Service Oil F1, MD-302

Cartridges



- > Replace cartridges immediately if they display faults or leak!
- > Do not expose the cartridges to direct sunlight!
- > The level of cartridges may differ of 5-10%. A residual may be present in one of the cartridges when when the other one is finish.



The cartridge spike in the medical device is sharp.
Be careful not to injure yourself on the projecting spike.

6. Description

Front panel

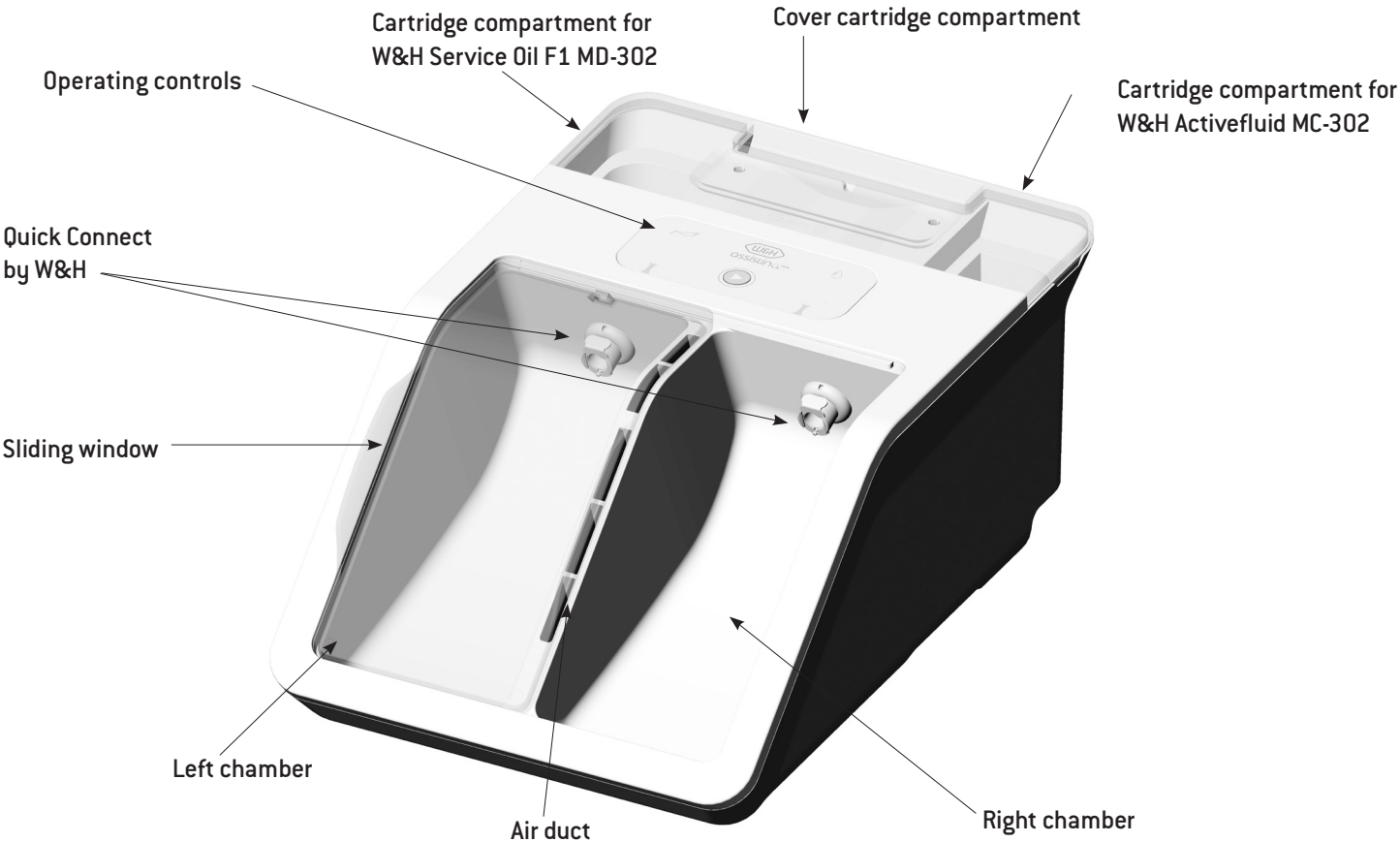

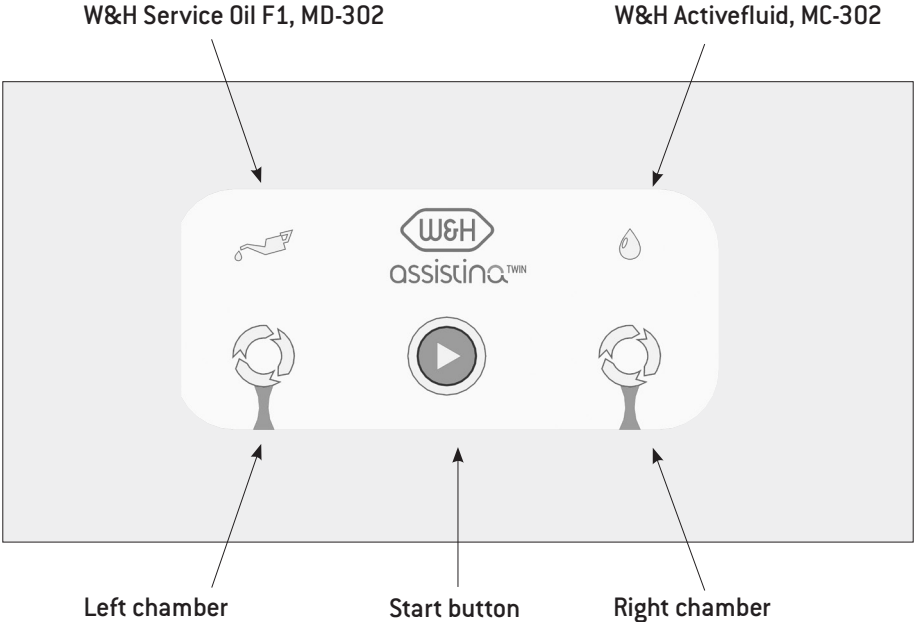

Description

Quick ISO/Quick RM adaptor

Quick ISO adaptor

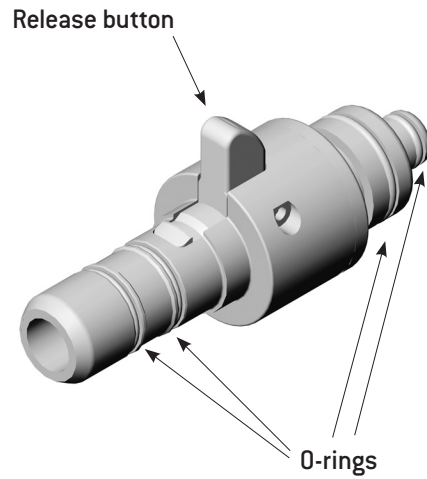

Quick RM adaptor

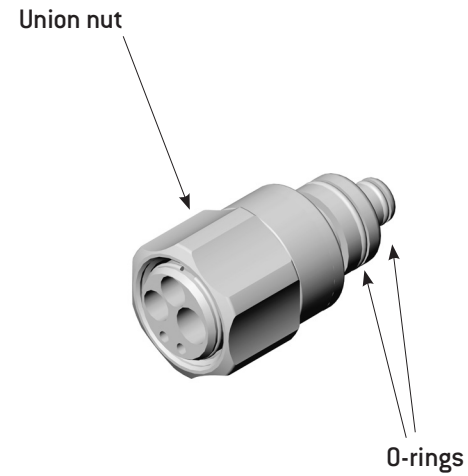

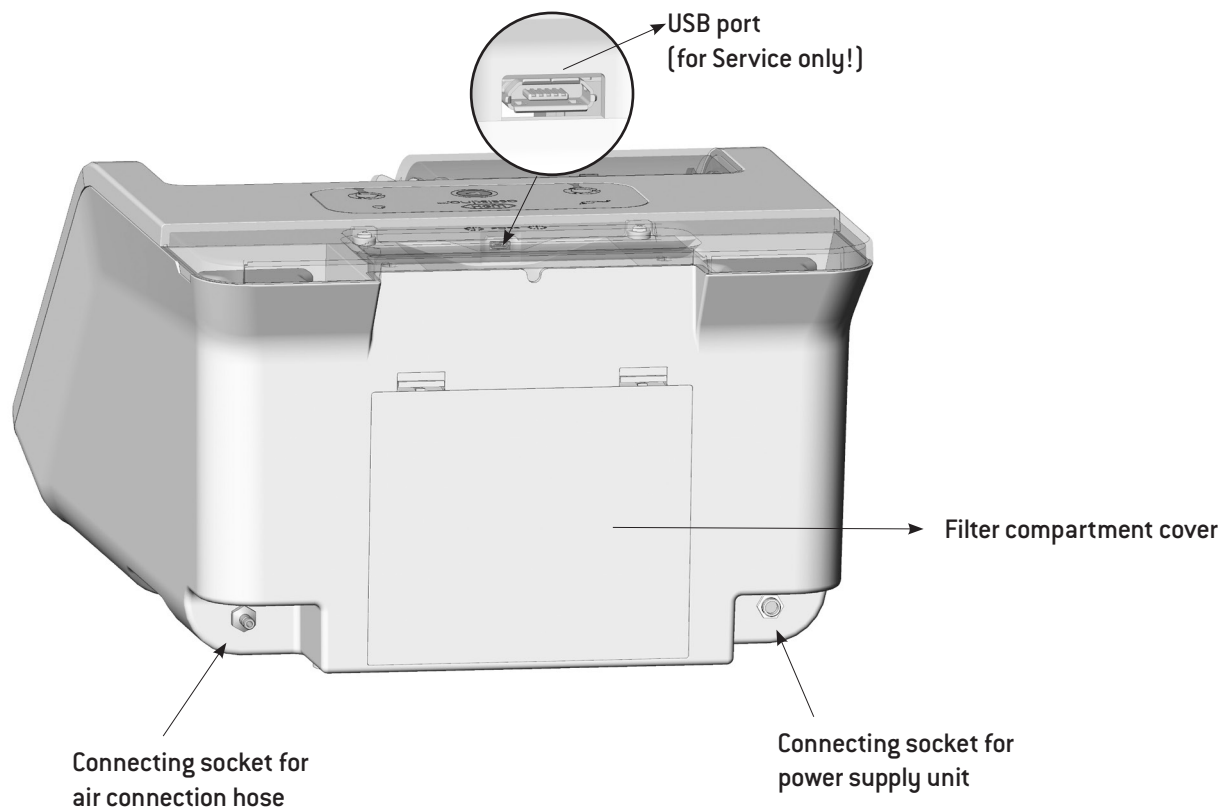

7. Start-up

Inserting/removing a cartridge



The cartridges must be at room temperature when they are inserted.



The cartridge spike in the medical device is sharp.
Be careful not to injure yourself on the projecting spike.

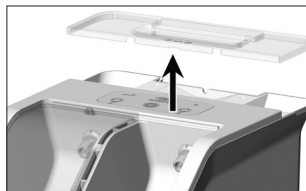

- ❶ Remove the cartridge compartment cover.**

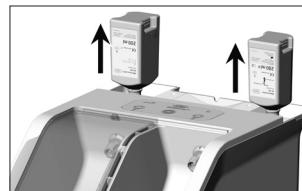

- ❸ Removing a cartridge**
Pull out the cartridge.

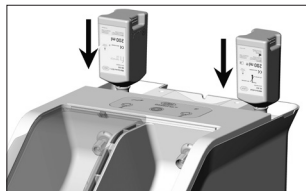

- ❷ Inserting a cartridge**
Push the cartridge in until the limit stop is reached.

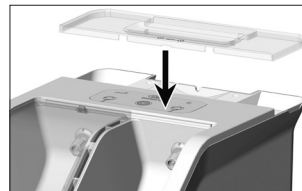

- ❹ Replace the cartridge compartment cover.**



Whenever you replace a cartridge:

- > always clean the cartridge compartment,
 - > perform the initial filling.
- Observe the manufacturer's instructions on the use of disinfectant.

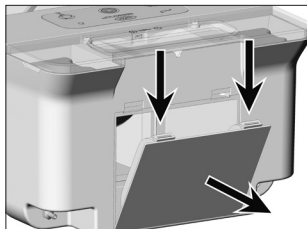

- ❶ Open the filter compartment cover.

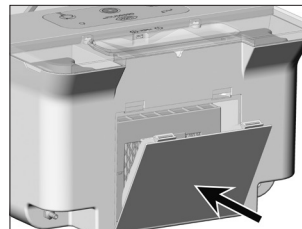

- ❸ Close the filter compartment cover.

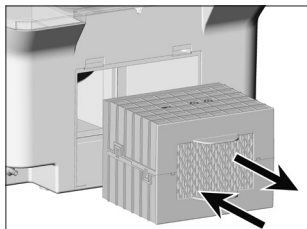

- ❷ **Inserting/removing a filter**
- > Push the filter in until the limit stop is reached.
 - > Pull out the filter.



Always clean the filter compartment whenever you replace a filter.
Observe the manufacturer's instructions on the use of disinfectant.



Use only non-contaminated, oil-free, dry and filtered compressed air according to ISO 7494-2.
Replace the filter if contaminated.

Connecting/disconnecting the air connection hose

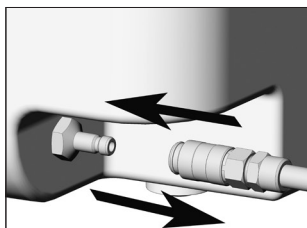

- 1 Connect the air connection hose.
- 2 Disconnect the air connection hose.

Connecting the power supply unit

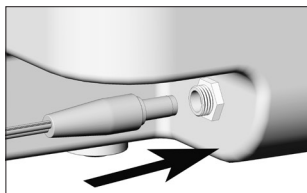

- 3 Connect the power supply unit to the medical device.

Start-up

Switching the Assistina Twin on/off

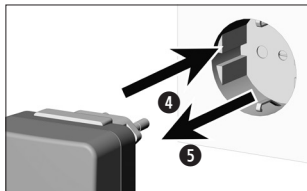

④ Plug the power supply unit into a power socket.

⑤ Pull the power supply unit out of the socket.

Start-up

Activating/deactivating the blow-through function (optional)



- > Activate the blow-through function to minimise liquid residues in the transmission instrument.
- > Ensure that the device is switched on before activating the blow-through function.

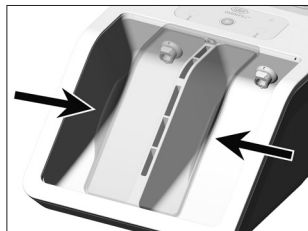

- ❶ Move the sliding window to the centre position.

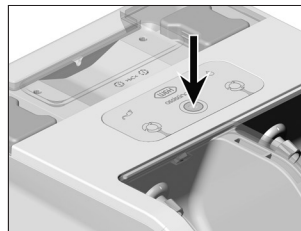

- ❷ Press the start button for 5 seconds.

Activating



- > A signal tone sounds
- > The LED start button lights up dark blue for 1 second.



Deactivating



- > A signal tone sounds
- > The LED start button lights up green for 1 second.



The activation/deactivation state of the blow-through function is stored and remains even after the device is switched off/placed in standby mode.



- > Carry out the initial filling without a transmission instrument.
- > It does not matter which chamber you fill first.



- 1 Close one chamber using the sliding window.

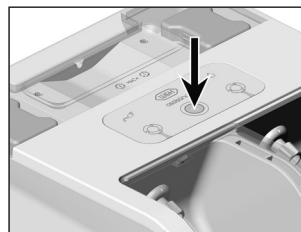

- 2 Press the "Start" button for approx. 5 seconds.



The initial filling of the first chamber will take approx. 1 minute.



- > The LED for the chamber flashes green.
- > The W&H Service Oil and W&H Activefluid LED are green.



The initial filling of the first chamber has completed successfully.



- > The LED for the first chamber is green.
- > The LED for the second chamber is orange.
- > The W&H Service Oil and W&H Activefluid LED are green.



3 Close the other chamber using the sliding window.



The initial filling continues automatically.



The initial filling of the second chamber will take approx. 1 minute.



- > The LED for the chamber flashes green.
- > The W&H Service Oil and W&H Activefluid LED are green.



The initial filling has completed successfully.



The LED for both chambers are green.



Following the initial filling, clean both chambers with a damp cloth.

Start-up

Standby mode



The medical device switches to standby mode:

- > when the power supply unit is inserted into the socket; or
- > if it is not operated for 15 minutes.



All LED are off.

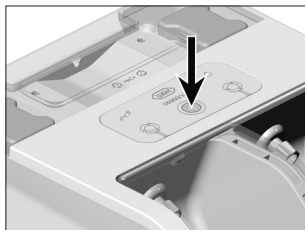

Activating the Assistina Twin

Press the "Start" button.



All of the LED are white for 1 second.
A signal tone sounds.

Ready for use



The start button is green.

- > Place a pre-disinfected transmission instrument onto the Quick Connect.
- > Start the Assistina Twin.



The transmission instrument will be slightly moist when you take it out.
It then needs to be manually disinfected and sterilized.



In the event of operating malfunctions (e.g., vibrations, unusual noise, overheating, failure or leakage) **stop the medical device immediately** and contact an authorized W&H service partner.



Wear protective clothing, safety glasses, face mask and gloves.





Refer to the "hygiene and maintenance" instructions in the instructions for use of the transmission instruments.

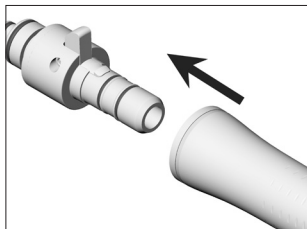

Replace damaged or leaking O-rings immediately.

Loading the transmission instruments with ISO connection



- 1 Push the transmission instrument onto the adaptor, with the coolant outlet facing downwards.
 For air motors, set the direction of rotation via the switching ring to clockwise or anti-clockwise. No maintenance is carried out in the "0" position.

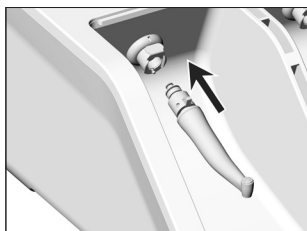

- 2 Push on the transmission instrument with adaptor.

Removing the transmission instruments with ISO connection

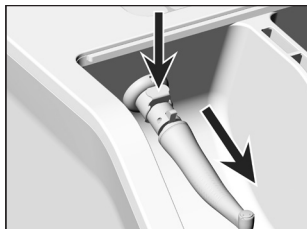

❶ Press the release button and pull off the transmission instrument with adaptor.

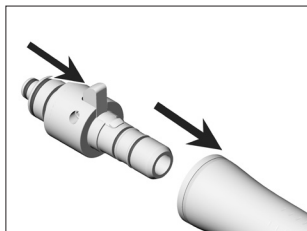

❷ Tip the release button on the adaptor forwards and remove the transmission instrument.

Operation

Loading/removing with Quick RM adaptor

Loading of the transmission instruments and/or adaptors with fixed RM connection

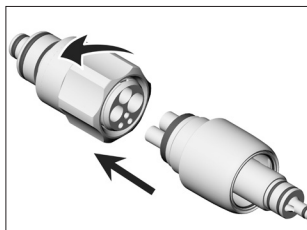

- 1 Push on the transmission instrument and/or adaptor on the Quick RM adaptor and tighten the union nut anti-clockwise by hand.

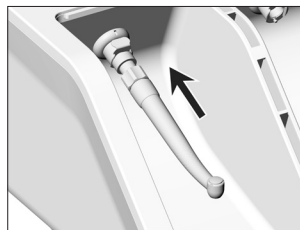

- 2 Push on the Quick RM adaptor with transmission instrument or, if applicable, the adaptor with transmission instrument.

Removing of the transmission instruments and/or adaptors with fixed RM connection

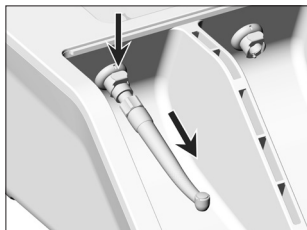

- 1 Press the release button and pull off the Quick RM adaptor, transmission instrument or, if applicable, adaptor with transmission instrument.

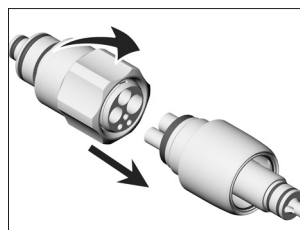

- 2 Unscrew the union nut by hand in a clockwise direction and remove the transmission instrument/adaptor.

-  > The amount of W&H Activefluid, MC-302 and W&H Service Oil F1, MD-302 used in the maintenance process is carefully metered.
- > The maintenance process always runs automatically and identically in both chambers.

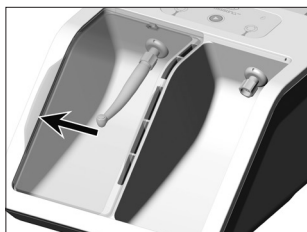

1 Close the sliding window.



2 Press the "Start" button.

 If the preset option for the blow-through function is selected, it is automatically activated for approx. 5 seconds before the maintenance process begins.

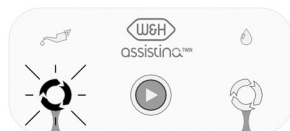

The maintenance process is performed.

-  > The LED flashes green.
> The maintenance process runs automatically and takes approx. 10 seconds.



The maintenance process has completed successfully.

-  > The LED for the chamber is green.
> A signal tone sounds.

Operation

Lubrication of the chucking system

- > Remove the rotary instrument.
- > Use the Quick ISO adaptors REF 06422600 and REF 02693000.
- > It is possible to oil the chucking system in both chambers.



❶ Close the sliding window.



❷ Insert the adaptor with the maintenance attachment facing downwards.

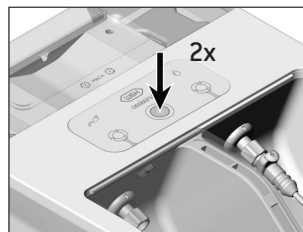

❸ Press the "Start" button twice.



The start button is purple.

Operation

Lubrication of the chucking system

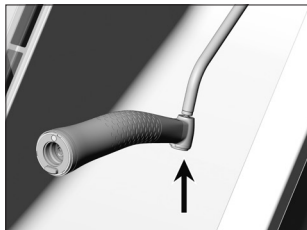

- ④ Align the instrument with the outlet.

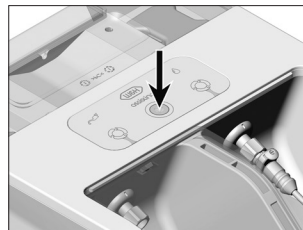

- ⑤ Press the "Start" button.



The lubrication is performed.



- > The LED flashes purple.
- > The lubrication runs automatically and takes approx. 5 seconds.



Wear protective clothing, safety glasses, face mask and gloves.
Aerosol mist escapes.



The lubrication has completed successfully.



- > The LED for the chamber and the start button are purple.
- > A signal tone sounds.

Continuing the lubrication

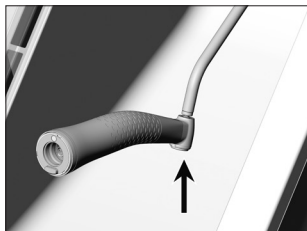

- ⑥ Align the instrument with the outlet.



- ⑦ Press the "Start" button.

Finishing the lubrication

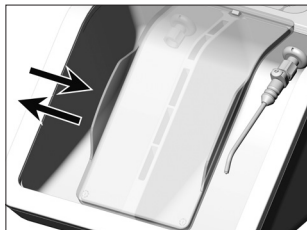

- ⑧ Open and close the sliding window.
The start button LED is green.

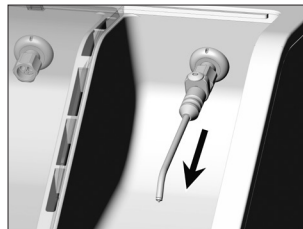

- ⑨ Remove the adaptor.



- > Follow your local and national laws, directives, standards and guidelines for cleaning and disinfection.
- > W&H recommends cleaning the medical device at least once daily or as required.



Wear protective clothing, safety glasses, face mask and gloves.



Cleaning agents

Use only detergents which are intended for cleaning medical devices made of metal and plastic.

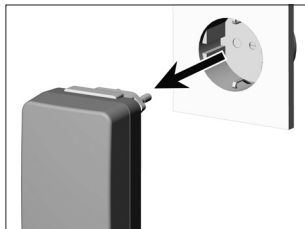

- 1 Switching OFF**
Unplug the medical device
from the mains supply.



- 2 Remove the sliding window.**

Manual cleaning of the interior and exterior



- Clean the chambers with a dry cloth.
Wipe down the exterior and the chambers with disinfectant.

Sliding window

Manual cleaning of the interior and exterior

Rinse the sliding window off with running tap water [$<35^{\circ}\text{C}$ / 95°F] and wipe down with disinfectant.

Start-up after cleaning

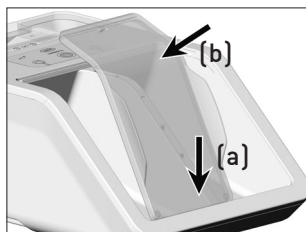

- 1 Insert the sliding window.

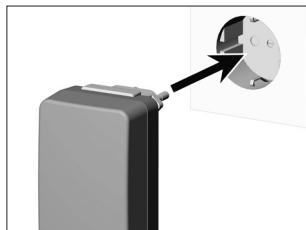

- 2 **Switching ON**
Connect the medical device to the mains supply.

10. Maintenance

Replacing O-rings



Replace damaged or leaking O-rings immediately.
Do not use sharp tools!

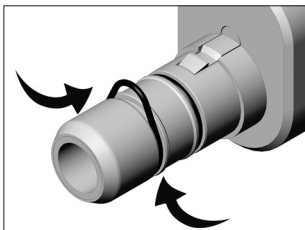

- 1 Firmly squeeze the O-ring between your thumb and index finger so that it forms a loop.

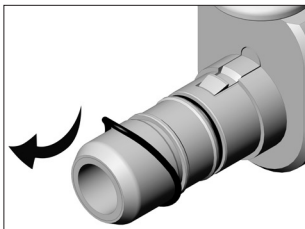

- 2 Pull off the O-ring.

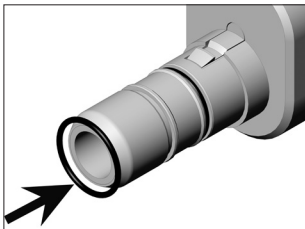

- 3 Slide on a new O-ring.



Switch off the central air supply before replacing the air filter.



- > Replace the air filter whenever it is dirty or at least once per year.
- > Only use clean, filtered compressed air.

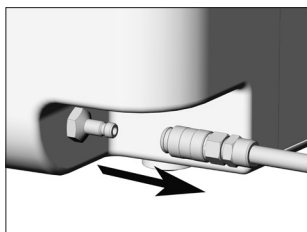

- 1** Remove the air connection hose.

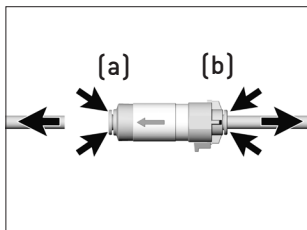

- 2** Push the ring [a, b] towards the air filter and detach the air hose.

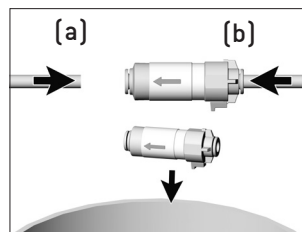

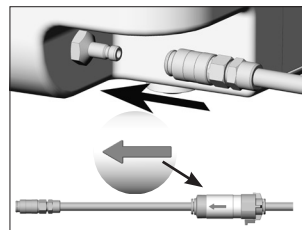

- 3** Replace the air filter and re-connect the air hose [a, b].





- 4** Connect the air hose.
Pay attention to the flow direction of the air filter.



11. Error messages

LED display	Description	Solution
 <p>No LED lit up.</p>	<p>Medical device in standby mode</p> <p>or</p> <p>Medical device not connected to the mains supply.</p>	<p>> Press the "Start" button.</p> <p>> Connect the power supply.</p>
 <p>The LED for the chambers <u>and</u> the start button are red.</p>	<p>Electronics error</p>	<p>> Unplug medical device and plug back in.</p> <p>> Press the "Start" button.</p> <p>Same error occurs again:</p> <p>> Send the entire medical device to an authorized W&H service partner.</p>
 <p>LED for chambers are orange.</p>	<p>Sliding window is open.</p>	<p>> Close the sliding window.</p>



Error messages

LED display	Description	Solution
 <p>The start button LED is blue.</p>	<p>Problem with air supply.</p>	<ul style="list-style-type: none"> > Restore the air supply.
 <p>The LED for the right or left chamber is red. The start button LED is green.</p>	<p>The maintenance process did not complete successfully.</p>	<ul style="list-style-type: none"> > Press the "Start" button. > Repeat the maintenance process.
 <p>The LED for the right or left chamber is red. The start button LED is blue.</p>	<p>The maintenance process did not complete successfully – problem with air supply.</p>	<ul style="list-style-type: none"> > Restore the air supply. > Press the "Start" button. > Repeat the maintenance process.



Error messages

LED display	Description	Solution
 <p>The LED for the right <u>or</u> left chamber, the W&H Service Oil LED <u>and</u> W&H Activefluid LED are red. The start button LED is green.</p>	<p>The initial filling did not complete successfully.</p>	<ul style="list-style-type: none"> > Check if the cartridges are: <ul style="list-style-type: none"> > connected correctly; > empty (replace cartridge). > Press the "Start" button. > Repeat the initial filling.
 <p>The LED for the right <u>or</u> left chamber, the W&H Service Oil LED <u>and</u> W&H Activefluid LED are red. The start button LED is blue.</p>	<p>The initial filling did not complete successfully. Problem with air supply.</p>	<ul style="list-style-type: none"> > Restore the air supply. > Press the "Start" button. > Repeat the initial filling.

Error messages

LED display	Description	Solution
 <p>The W&H Service Oil <u>and</u> W&H Activefluid LED are orange.</p>	<p>The cartridges are almost empty.</p>	<p>> Replace the cartridges as soon as possible.</p>
 <p>The W&H Service Oil <u>and</u> W&H Activefluid LED are red.</p>	<p>The cartridges are empty.</p>	<p>> Replace the cartridges. > Carry out the initial filling.</p>

Error messages

LED display	Description	Solution
 <p>The LED for the right <u>or</u> left chamber is red. The start button LED is purple.</p>	<p>The lubrication of the chucking system did not complete successfully.</p>	<ul style="list-style-type: none"> > Press the "Start" button. > Repeat the lubrication.
 <p>The LED for the right <u>or</u> left chamber is red. The start button LED is blue.</p>	<p>The lubrication of the chucking system did not complete successfully. Problem with air supply.</p>	<ul style="list-style-type: none"> > Restore the air supply. > Press the "Start" button. > Repeat the lubrication.

If the described problem cannot be resolved, the unit will need to be inspected by an authorized W&H service partner.

- > Disconnect the medical device from the air connection hose and power supply unit.
- > Remove the instruments and cartridges from the medical device.

12. Accessories, consumables, spare parts and other recommended medical devices by W&H



Use only original W&H accessories and spare parts or accessories approved by W&H!



06395100
Quick RM adaptor



06422600
Quick ISO adaptor



02679000
Adaptor for lubricating the
chucking system

Für weitere Adapter und die komplette Systemübersicht QR-Code scannen:



Accessories, consumables, spare parts and other recommended medical devices by W&H



02697000

Air connection hose (2 m)

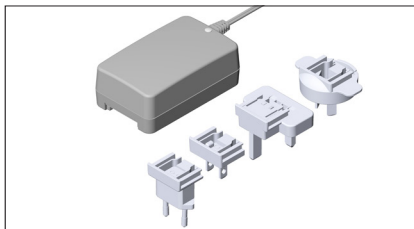

07477500

Power supply unit MB-302



02060100

O-ring, Roto Quick adaptor, large

02060200

O-ring, Roto Quick adaptor, small

03006100

O-Ring, Quick RM and
Quick ISO adaptor, large

01208300

O-Ring, Quick RM and
Quick ISO adaptor, small

02695700

O-ring, Quick ISO adaptor

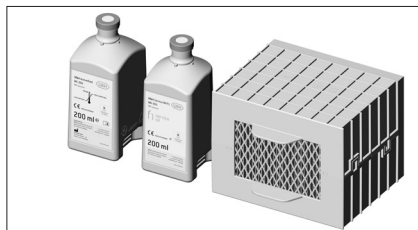

07484000

Twin Care SET
MB-302



02675200

Air filter

13. Servicing

Repairs and returns

In the event of operating malfunctions immediately contact an authorized W&H service partner.

Repairs and maintenance work must only be undertaken by an authorized W&H service partner.



Always return equipment in the original packaging!

14. Technical data

Assistina Twin	MB-302
Supply voltage:	100 – 240 V AC
Permitted voltage fluctuation:	±10%
Nominal current:	0.4 – 0.2 A
Frequency:	50 – 60 Hz
Max. power consumption:	18 VA
Air consumption:	approx. 40 NI/min.
Operating pressure:	73 – 145 psi (5 – 10 bar) (controlled via an integrated, automatic pressure controller)
Volume:	60 dB
Dimensions in mm (WxDxH):	11.7" x 17.1" x 7.5" (297 x 435 x 190 mm)
Weight:	8.4 lbs (3.8 kg)
Capacity:	200 ml W&H Activefluid, MC-302 200 ml W&H Service Oil F1, MD-302

Technical data

Ambient conditions

Temperature during transport:	+32 °F to +122 °F (0 °C to +50 °C)
Temperature during storage:	+41 °F to +104 °F (+5 °C to +40 °C)
Humidity during storage and transport:	8% to 80% (relative), non-condensing
Ambient temperature during operation:	+50 °F to +104 °F (+10 °C to +40 °C)
Humidity during operation:	15% to 80% (relative), non-condensing
Pollution level:	2
Overvoltage category:	II
Altitude:	up to 9,843 ft (3,000 m) above sea level

15. Disposal



Ensure that the parts are not contaminated on disposal.



Follow your local and national laws, directives, standards and guidelines for disposal.

- > Medical device
- > Waste electrical equipment
- > Packaging

Explanation of warranty terms

This W&H medical device has been manufactured with great care by highly qualified specialists. A wide variety of tests and controls guarantee faultless operation. Please note that claims under warranty can only be validated when all the directions in the instructions for use have been followed.

As the manufacturer, W&H is liable for material or manufacturing defects within a warranty period of 24 months from the date of purchase.

We accept no responsibility for damage caused by incorrect handling or by repairs carried out by third parties not authorized to do so by W&H.

Claims under warranty – accompanied by proof of purchase – must be sent to the vendor or to an authorized W&H service partner. The provision of service under warranty extends neither the warranty period nor any other guarantee period.

24 months warranty

Authorized W&H service partners

Find your nearest W&H service partner at <http://wh.com>
Simply go to the menu option "Service" for full details.

Or simply scan the QR code.





W&H Dentalwerk Bürmoos GmbH
Ignaz-Glaser-Straße 53, 5111 Bürmoos, Austria

t +43 6274 6236-0, f +43 6274 6236-55
office@wh.com wh.com

Form-Nr. 50927 AAE
Rev. 007 / 20.05.2025
Subject to alterations